

SWITCH BOARD SPECIFICATION

GENERAL SPECIFICATION

CUBICLE SPECIFICATION

POWER SYSTEM VOLTAGE		CUBICLE & PANEL BOARD	
<input type="radio"/> LOW VOLTAGE <input type="radio"/> : 3ø 4W. 416/240VAC. 50Hz <input type="radio"/> : 3ø 4W. 400/230VAC. 50Hz <input type="radio"/> : 3ø 4W. 380/220VAC. 50Hz <input type="radio"/> : 3ø 3W. 200V. 50Hz <input type="radio"/> : OTHERS		<input type="radio"/> MEDIUM VOLTAGE <input type="radio"/> : 3ø 22kVAC. 50Hz <input type="radio"/> : 3ø 24kVAC. 50Hz	
BUSBAR	CABLE TYPE	PANEL CUBICLE (BEND & WELD)	FRAME CUBICLE (KNOCK-DOWN)
STANDARD <input type="radio"/> : IEC 439-1 <input type="radio"/> : ANSI C37.20 <input type="radio"/> : DIN 43671 <input type="radio"/> : BS 159 <input type="radio"/> : OTHERS	POWER CABLE <input type="radio"/> : TYPE THW (BLACK) WITH CABLE CAP <input type="radio"/> : TYPE VSF (BLACK) WITH CABLE CAP <input type="radio"/> : OTHERS TYPE <input type="radio"/> : REQUEST TERMINAL BLOCK FOR INCOMING <input type="radio"/> : REQUEST TERMINAL BLOCK FOR OUTGOING NOTE : SIZE AS DRAWING	TYPE <input checked="" type="radio"/> : INDOOR <input checked="" type="radio"/> : FORM 1 <input type="radio"/> : OUTDOOR <input type="radio"/> : FORM 2A <input checked="" type="radio"/> : FLOOR STANING <input type="radio"/> : FORM 2B <input checked="" type="radio"/> : WALL MOUNTING <input type="radio"/> : FORM 3A <input type="radio"/> : FORM 3B <input type="radio"/> : FORM 4A <input type="radio"/> : FORM 4B	<input type="radio"/> : INDOOR <input type="radio"/> : FORM 1 <input type="radio"/> : OUTDOOR <input type="radio"/> : FORM 2A <input type="radio"/> : FLOOR STANING <input type="radio"/> : FORM 2B <input type="radio"/> : WALL MOUNTING <input type="radio"/> : FORM 3A <input type="radio"/> : FORM 3B <input type="radio"/> : FORM 4A <input type="radio"/> : FORM 4B
MATERIAL FOR BUSBAR <input type="radio"/> : BARE COPPER <input type="radio"/> : COATED COPPER <input type="radio"/> : ALUMINIUM <input type="radio"/> : Tin.CU. <input type="radio"/> : HEAT SHRINKABLE <input type="radio"/> : OTHERS	RATED CURRENT <input type="radio"/> : BARE COPPER <input type="radio"/> : COATED COPPER	DEGREE OF PROTECTION <input checked="" type="radio"/> : IP 31 <input type="radio"/> : IP 54 <input type="radio"/> : IP 55 <input type="radio"/> : IP 56 <input type="radio"/> : OTHERS	<input type="radio"/> : IP 30 <input type="radio"/> : IP 54 <input type="radio"/> : IP 55 <input type="radio"/> : IP 56 <input type="radio"/> : OTHERS
PAINTING <input type="radio"/> : COATED <input type="radio"/> : MARKER <input type="radio"/> : HEAT SHRINK	CONTROL CABLE <input type="radio"/> POTENTIAL CIRCUIT (VOLTMETER) : Sq.mm. : COLOUR <input type="radio"/> CURRENT CIRCUIT (AMP METER) : Sq.mm. : COLOUR <input type="radio"/> CONTROL CAP., TIE & ATS : Sq.mm. : COLOUR <input type="radio"/> CONTROL WIRING (STARTER) : Sq.mm. : COLOUR	MATERIAL KIND <input checked="" type="radio"/> : COLD ROLL STEEL SHEET <input type="radio"/> : ELECTRO GALVANIZED STEEL SHEET <input type="radio"/> : HOT DIP GALVANIZED STEEL SHEET <input type="radio"/> : STANLESS STEEL 304 HL <input type="radio"/> : OTHER	<input type="radio"/> : COLD ROLL STEEL SHEET <input type="radio"/> : ELECTRO GALVANIZED STEEL SHEET <input type="radio"/> : HOT DIP GALVANIZED STEEL SHEET <input type="radio"/> : STANLESS STEEL <input type="radio"/> : OTHER
<input type="radio"/> :100.... % NEUTRAL <input type="radio"/> :25.... % GROUND	NAME PLATE <input type="radio"/> : PLASTIC PLATE <input type="radio"/> : STAINLESS <input type="radio"/> : OTHERS	THICKNESS BODY <input type="radio"/> 1.0 mm. <input checked="" type="radio"/> 1.2 mm. <input type="radio"/> 1.5 mm. <input type="radio"/> 2.0 mm. <input type="radio"/> : OTHER DOOR <input type="radio"/> 1.0 mm. <input checked="" type="radio"/> 1.2 mm. <input type="radio"/> 1.5 mm. <input type="radio"/> 2.0 mm. <input type="radio"/> : OTHER INNER PLATE <input type="radio"/> 1.0 mm. <input checked="" type="radio"/> 1.2 mm. <input type="radio"/> 1.5 mm. <input type="radio"/> 2.0 mm. <input type="radio"/> : OTHER <input type="radio"/> ROOF : mm. <input type="radio"/> BASE : mm.	<input type="radio"/> : COLD ROLL STEEL SHEET <input type="radio"/> : ELECTRO GALVANIZED STEEL SHEET <input type="radio"/> : HOT DIP GALVANIZED STEEL SHEET <input type="radio"/> : STANLESS STEEL <input type="radio"/> : OTHER FRAME <input type="radio"/> 2.0 mm. <input type="radio"/> 2.5 mm. <input type="radio"/> : OTHERmm. FRONT DOOR <input type="radio"/> 1.5 mm. <input type="radio"/> 2.0 mm. <input type="radio"/> : OTHERmm. SIDE/REAR DOOR <input type="radio"/> 1.5 mm. <input type="radio"/> 2.0 mm. <input type="radio"/> : OTHERmm. PARTITION <input type="radio"/> 1.5 mm. <input type="radio"/> 2.0 mm. <input type="radio"/> : OTHERmm. OTHERS PARTS <input type="radio"/> 1.5 mm. <input type="radio"/> 2.0 mm. <input type="radio"/> : OTHERmm. <input type="radio"/> ROOF : mm. <input type="radio"/> BASE : mm.
PHASE COLOUR FOR BUSBAR <input type="radio"/> : RED, YELLOW, BLUE, WHITE, GREEN <input type="radio"/> : BLACK, RED, BLUE, WHITE, GREEN <input type="radio"/> : BROWN, BLACK, GRAY, BLUE SKY, GREEN <input type="radio"/> : OTHERS	MIMIC DIAGRAM <input type="radio"/> : BLACK (NORMAL) <input type="radio"/> : RED (EMERGENCY) <input type="radio"/> : OTHERS	PAINTING <input type="radio"/> : RAL.7036 GRAY SMOOTH <input type="radio"/> : 5Y7/1 CREAM SMOOTH <input type="radio"/> : 5Y8/1 <input type="radio"/> : RAL.7035 GRAY WRINKLED <input checked="" type="radio"/> : RAL.7032 CREAM WRINKLED <input type="radio"/> : PF60007A RED SMOOTH	<input type="radio"/> : RAL.7036 GRAY SMOOTH <input type="radio"/> : 5Y7/1 CREAM SMOOTH <input type="radio"/> : 5Y8/1 <input type="radio"/> : RAL.7038 GRAY WRINKLED <input type="radio"/> : RAL.7032 CREAM WRINKLED <input type="radio"/> : OTHER CREAM WRINKLED. (PW20289D)

Page : 1/2

 ENTGROUP CO.,LTD. (สำนักงานใหญ่) เลขที่ 70/5 หมู่ 4 เมทโทร มีขทาวน แจ่งวัฒนะ2 ถ.หอการค้าไทย ต.คลองพระอุดม อ.ปากเกร็ด จ.นนทบุรี 11120 โทร 02-045-6104 แฟกซ์ 02-045-6105	ปฏิบัติงานวันที่: 10/07/23 ส่งงานวันที่: 10/07/23		QTY: 1	JOB NO: -	QT NO: -	COLOR : คีรีมขุ่น (RAL 7032)			
	C		CUSTOMER :			DRAW . BY	N.MONGKOL	DATE 10/07/23	
	B		E.N.T. Group			CHECK . BY	N.MONGKOL	DATE 10/07/23	
	A	10/07/23	REV00	N.MONGKOL	S.SUTTIPONG	PROJECT	ตู้ขนาด 500x500x120mm.	APPROVED BY	S.SUTTIPONG
	DATE	DESCRIPTION	BY	APPROVED	MATERIAL : SPCC 1.2 MM		EDITION 00	ALL DIMENSION TOLERANCES ± 2.0 mm.	UNIT mm.

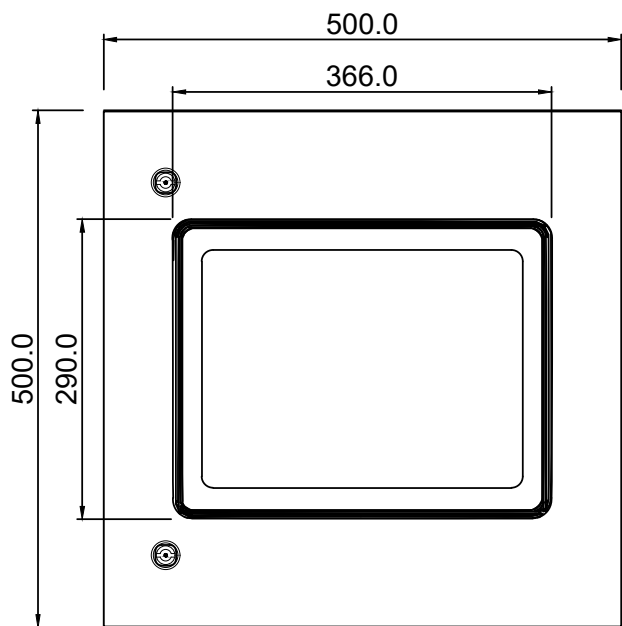

FRONT VIEW

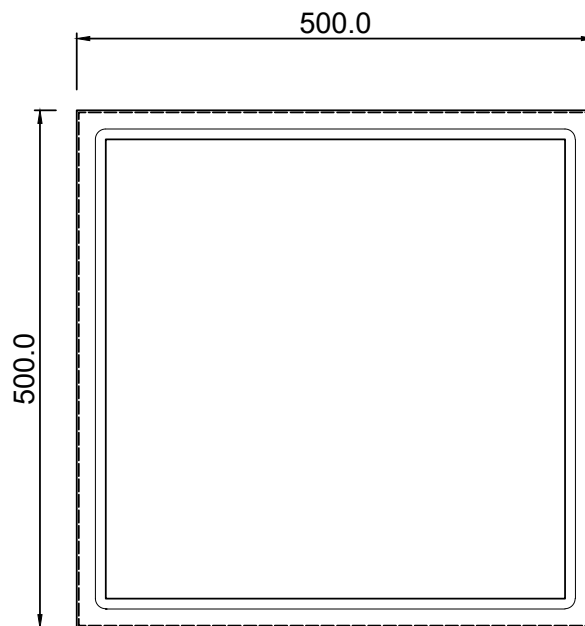

INNER VIEW

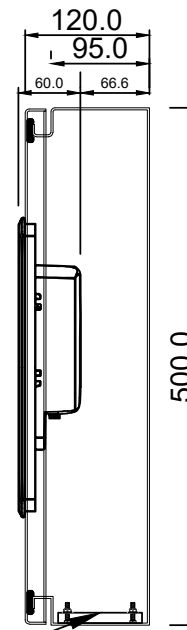

SECTION VIEW

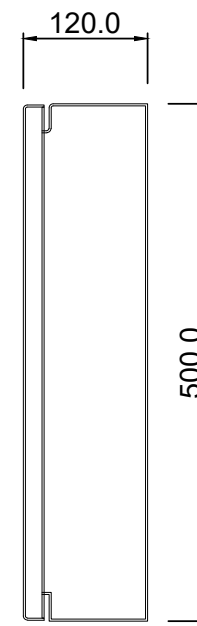

SIDE VIEW

PLATE 480x80 m.m.

ENT GROUP
 กรุณาตรวจสอบแบบ
 หากไม่มีการแก้ไขใดๆทั้งสิ้นรบกวนเซ็นต่อนุมัติแบบกลับค่ะ
 ผู้อนุมัติแบบกลับ.....
 ลงวันที่.....
 ส่งกลับ FAX : 02-045-6105 / ID LINE : @entgroup



ENTGROUP CO.,LTD. (สำนักงานใหญ่)
 เลขที่ 70/5 หมู่ 4 เมทโทร บิซทาวน์ แจ้งวัฒนะ2 ถ.พหลโยธิน
 ต.คลองพระอุดม อ.ปากเกร็ด จ.นนทบุรี 11120
 โทร 02-045-6104
 แฟกซ์ 02-045-6105

รับงานวันที่: 10/07/23		ส่งงานวันที่: 10/07/23		QTY: 1	JOB NO: -	QT NO: -	COLOR : ครีมเข้ม (RAL7032)		
REVISIONS	C				CUSTOMER :		DRAW . BY	N.MONGKOL	DATE 10/07/23
	B				E.N.T. Group		CHECK . BY	N.MONGKOL	DATE 10/07/23
	A	10/07/23	REV00	N.MONGKOL	S.SUTTIPONG	PROJECT	ผู้ขนาด 500x500x120mm.	APPROVED BY	S.SUTTIPONG
	DATE	DESCRIPTION	BY	APPROVED	MATERIAL :	STL HL 1.2 MM	EDITION	00	ALL DIMENSION TOLERANCES ± 2.0 mm. UNIT mm.



IT Service Specialist
 งานไอที งานเน็ต

Mini PC
 Factory outlet